



# JUNIPER

TIMBER COURT

# BUILDING PLAN

DRAFT



LEVEL 4



LEVEL 5



LEVEL 2



LEVEL 3

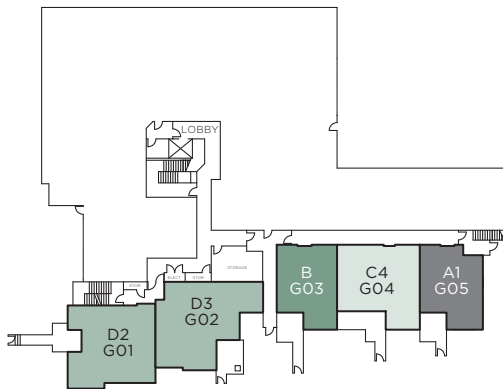

GROUND LEVEL



LEVEL 1



**A SERIES**  
1 Bedroom, 1 Bathroom  
Approx. 695 Sq.Ft.

**B SERIES**  
1 Bedroom + Den, 1 Bathroom  
Approx. 656 - 760 Sq.Ft.

**C SERIES**  
2 Bedroom, 2 Bathroom  
Approx. 912 - 980 Sq.Ft.

**D SERIES**  
2 Bedroom, 2 Bathroom  
Approx. 888 - 1,062 Sq.Ft.

**E SERIES**  
3 Bedroom, 2 Bathroom  
Approx. 1,135 Sq.Ft.

THE DEVELOPER RESERVES THE RIGHT TO MAKE MODIFICATIONS OR SUBSTITUTIONS SHOULD THEY BE NECESSARY.  
ANY MEASUREMENTS PROVIDED ARE APPROXIMATE ONLY. THE QUALITY RESIDENCES AT JUNIPER ARE BUILT BY POLYGON JUNIPER HOMES LTD.  
THIS IS CURRENTLY NOT AN OFFERING FOR SALE. ANY SUCH OFFERING CAN ONLY BE MADE BY WAY OF A DISCLOSURE STATEMENT. E. & O.E. 01/30/17