

Fifth Floor

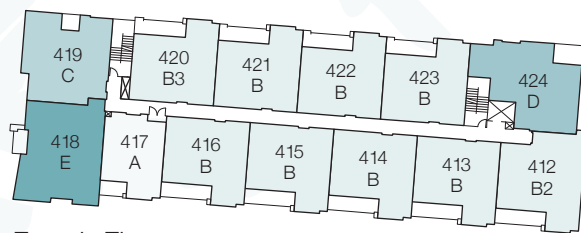

Fourth Floor

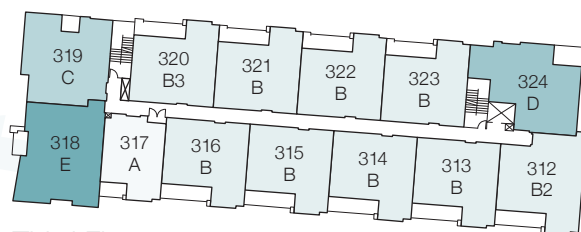

Third Floor

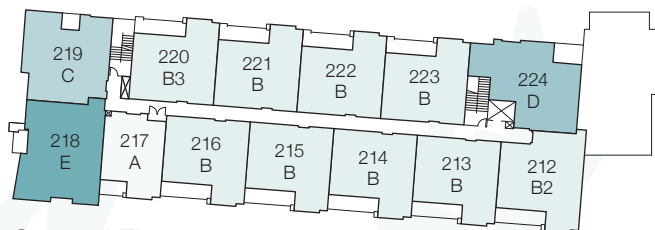

Second Floor

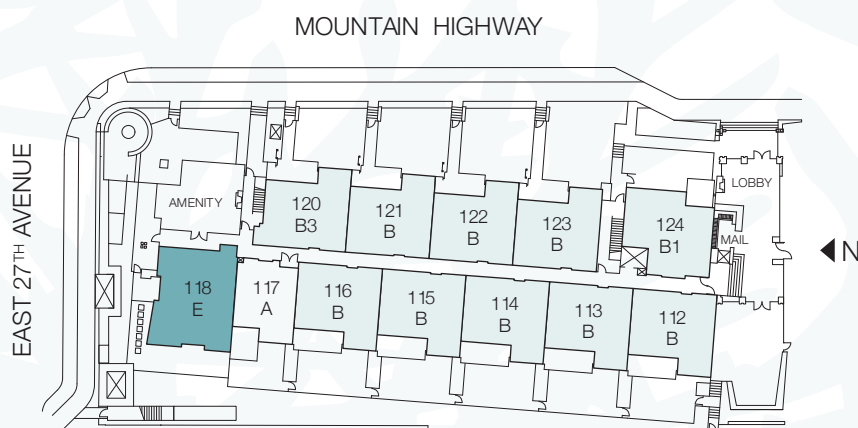

Ground Floor

- Avanti | Plan A**  
 One bedroom  
 628 – 655 sq.ft. (approx.)
- Brodie | Plan B, B1, B2, B3**  
 Two bedroom  
 836 – 962 sq.ft. (approx.)
- Cove | Plan C**  
 Two bedroom  
 960 – 980 sq.ft. (approx.)
- Dawes | Plan D**  
 Three bedroom  
 999 – 1,009 sq.ft. (approx.)
- Ellsworth | Plan E**  
 Three bedroom  
 1,091 – 1,111 sq.ft. (approx.)